

# Guide to the Auburn Library

## GENEALOGY SECTION

350 Nevada Street, Auburn, California  
(530) 886-4500

Online Catalog: [www.placer.ca.gov/departments/library](http://www.placer.ca.gov/departments/library)

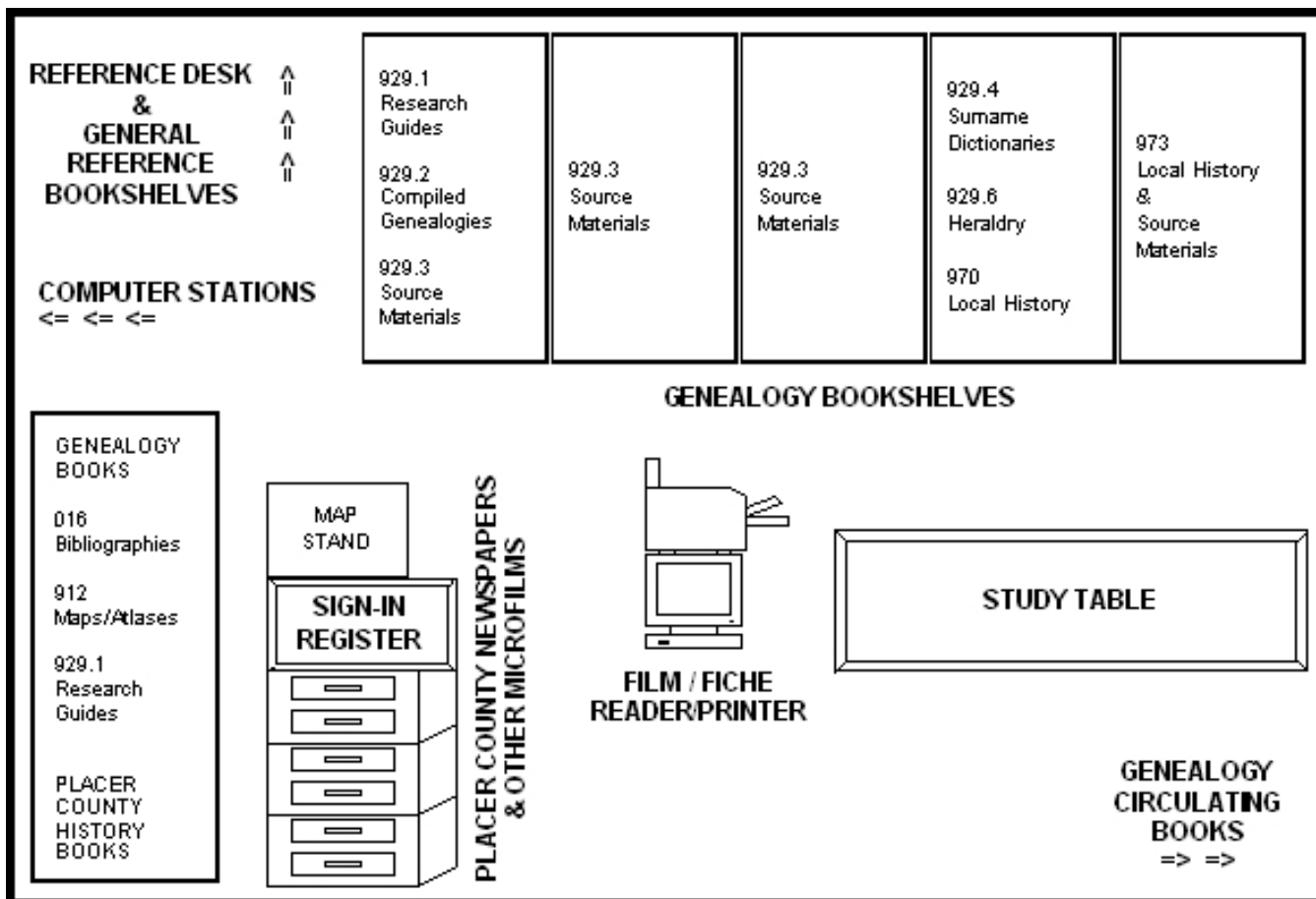

### Library Hours

Monday ~~10:00 am~~ -- 7:00 pm  
Tuesday, Wednesday, Thursday - 10:00 am - 6:00 pm  
Friday & Saturday - 10:00 am - 5:00 pm

The Genealogy Section  
is sponsored by the

**Placer County Genealogical Society**  
<http://pcgs.pcgenes.com/>

### Recommended Research Guides

The Placer County Genealogical Society recommends the following research guides on the library's circulating shelves:

*Discover Your Family History Online: A Step-by-Step Guide to Starting Your Genealogy Search*, by Nancy Hendrickson  
(Call #929.1028 Hen)

*Unpuzzling Your Past: A Basic Guide to Genealogy*, by Emily Anne Croom  
(Call #929.1 Cro)

## Genealogy Resources

### Genealogy Sign-In Register

Please sign-in whenever you use the Genealogy Section.

### Shelf List

A quick-reference listing of the library's genealogy holdings. Located in the red binder on top of the microfilm cabinets.

### Genealogy Bookshelves

The book collection includes bibliographies, special atlases, research guides, compiled genealogies, source materials, surname dictionaries, heraldry, and local histories.

### Placer County Local History Bookshelves

The local history collection includes books on Placer County communities and people. Some include biographical sketches on local citizens of the past.

### Newspaper Microfilm Cabinet

On microfilm are Placer County newspapers dating from 1852 to the present. Titles include the *Auburn Journal*, *Colfax Record*, *Dutch Flat Forum*, *Newcastle News*, *Placer Argus*, *Placer County Leader*, *Placer County Republican*, *Placer Herald*, *Placer Times*, *Stars & Stripes*, and *Union Advocate*.

### Census & Other Microfilm Cabinet

On microfilm are Placer County cemetery records, the 1852 California state census, and the U.S. census for Placer and other California counties for the years 1850, 1860, 1870, 1880, 1900, 1910 and 1920.

### Microfilm/Microfiche Reader/Printer

Paper copies from microfilm or microfiche cost 25¢ per page. Pay at the Service & Information Desk.

### Computer Stations

Free access to the Internet is available in the library. Quick links to many genealogy web sites and online databases are on the "PCGS FHC Favorites" list at [http://pcgs.pcgenes.com/PCGS\\_Favorites.html](http://pcgs.pcgenes.com/PCGS_Favorites.html).

### Reference Librarians' Desk

See the reference librarian to place orders for interlibrary loan of books, microfilms and microfiche.

### Circulating Shelves

Several research guides are on the circulating shelves and available for check-out. Look for the 929.1 call number in the non-fiction section.

# Guide to the AUBURN LDS FAMILY HISTORY CENTER

1255 Bell Road, Auburn, California ☎ tel. (530) 823-3139

OPEN TO THE PUBLIC

HOURS: Tuesday & Thursday: 10:00 am - 9:00 pm; Wednesday & Friday: 10:00 am - 5:00 pm

## CARD CATALOG

Catalog of microfiche and microfilm available in-house. Four sections: Author/Title, Subject, Locality and Surname.

## BOOKS ON MICROFICHE

Worldwide holdings include reference books, atlases & gazetteers, Bible records, biographical indexes, cemetery records, census indexes, city directories, histories, compiled genealogies, manuscript collections, military & pension lists, probate/will indexes & abstracts, vital record indexes, and more. Use the card catalog to access these materials.

## MICROFILM

Various published and manuscript research records. Use card catalog to access materials held in-house. Additional microfilms may be ordered on loan from the Family History Library via the online FamilySearch Catalog.

## BOOKS

Popular reference guides include: *Map Guide to the US Federal Censuses 1790-1920*, *Everton's Handy Book for Genealogists*, *Research Outlines*, and *Guide to Genealogical Research in the National Archives of the United States*.

## FAMILYSEARCH COMPUTERS

Free access to the Internet and FamilySearch web site, plus fourteen premium websites: 19th Century British Newspapers, Alexander Street Press: American Civil War Collection, Ancestry.com, ArkivDigital Online, FindMyPast, Fold3, The Genealogist, Godfrey Memorial Library, HeritageQuest Online, Historic Map Works, NewspaperARCHIVES, Origins.net, Paper Trail, and World Vital Records. The online collections are worldwide and include census records, Social Security Death Index, cemetery recordings, vital records, immigration, land and military records, digitized books, newspapers, maps, and more. Access the premium web sites via the FHC Portal on the computers.

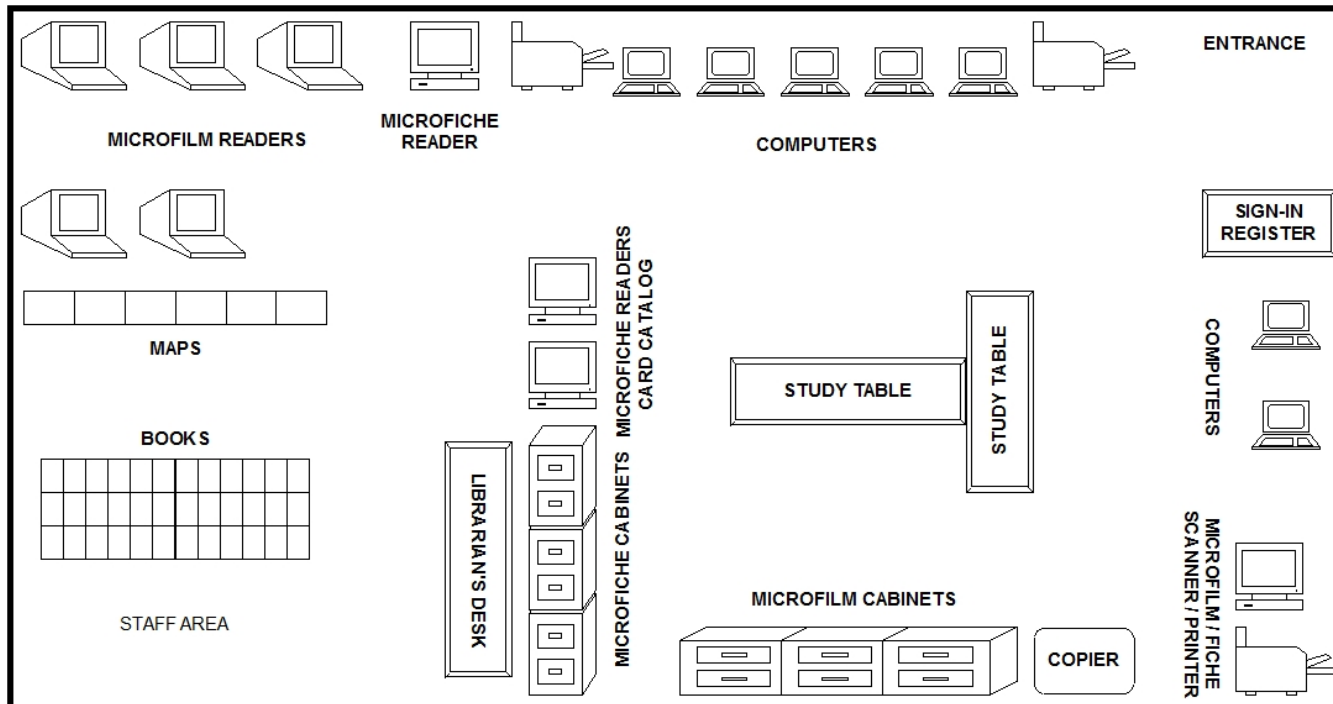

# Guide to the Auburn Library Genealogy Section

and the

# Auburn Family History Center

"A genealogist is usually not able to solve all his problems from a single repository, so he should plan to use several facilities before he has finished his work."

Norman E. Wright, MS, AG  
*Building an American Pedigree*

Placer County Genealogical Society  
Post Office Box 7385  
Auburn, California 95604-7385  
(866) 894-2076  
<http://pcgs.pcgenes.com/>